

Digitally signed by
Dennis Gabriele
Date: 2023.05.15
09:07:32 -4'00'

DATED: 05/11/2023
THIS ITEM HAS BEEN DIGITALLY SIGNED AND SEALED BY DENNIS GABRIELE ON THE DATE ADJACENT TO THE SEAL.

PRINTED COPIES OF THIS DOCUMENT ARE NOT CONSIDERED SIGNED AND SEALED AND THE SIGNATURE MUST BE VERIFIED ON ANY ELECTRONIC COPIES.

PZ23-12000015

06/21/2023

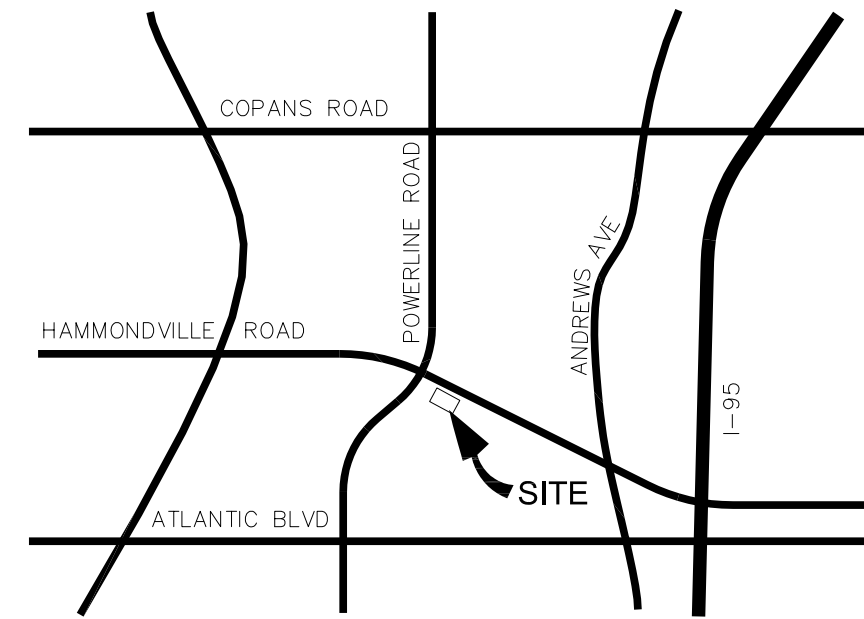
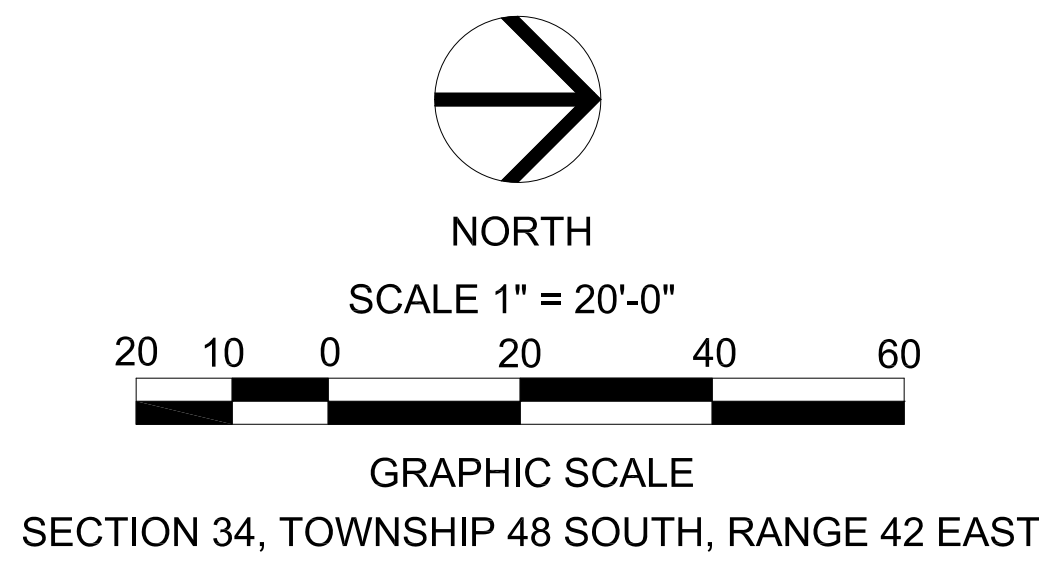

LOCATION SKETCH NTS

LEGEND:

- | | |
|---------------------------|--------------------|
| ANCHOR | MONITORING WELL |
| BACK FLOW PREVENTER | PALM TREE |
| BOLLARD | TREE |
| CONCRETE POWER POLE (CPP) | CONCRETE TIRE STOP |
| CATCH BASIN | SANITARY MANHOLE |
| ELECTRIC BOX | SIGN |
| EXISTING ELEVATION | UNKNOWN MANHOLE |
| FIRE HYDRANT | WATER VALVE |
| INLET | WATER METER |
| LIGHT POLE | |
| CHAIN LINK FENCE | |
| METAL FENCE | |
| NON-VEHICULAR ACCESS LINE | |

LEGAL DESCRIPTION:

A PORTION OF PARCEL A, AS SHOWN ON THE PLAT OF "PENTERIA INC., PLAT", ACCORDING TO THE PLAT THEREOF, AS RECORDED IN PLAT BOOK 166, PAGE 33, OF THE PUBLIC RECORDS OF BROWARD COUNTY, FLORIDA.

SAID LANDS LYING AND BEING IN THE CITY OF POMPAHO BEACH, BROWARD COUNTY, FLORIDA.

SURVEYOR'S NOTES:

ELEVATIONS SHOWN HEREON ARE BASED ON GPS OBSERVATION AS COLLECTED THROUGH THE FLORIDA PERMANENT REFERENCE NETWORK AND ARE REFERENCED TO THE NORTH AMERICAN VERTICAL DATUM OF 1988.

NO ATTEMPT WAS MADE TO LOCATE ANY UNDERGROUND UTILITIES EXCEPT AS SHOWN.

NO ATTEMPT WAS MADE TO DELINEATE ANY WETLANDS.

THIS SURVEY WAS PREPARED WITHOUT BENEFIT OF A TITLE COMMITMENT.

ALL RECORDS SHOWN HEREON ARE REFERENCED TO THE PUBLIC RECORDS OF BROWARD COUNTY, FLORIDA.

THE SPECIFIC PURPOSE OF THIS SURVEY IS TO SHOW THE EXISTING HORIZONTAL AND VERTICAL CONDITIONS OF THE LANDS SHOWN HEREON. ALL RIGHT-OF-WAY LINES SHOWN HEREON ARE FOR REFERENCE PURPOSES ONLY. THIS IS NOT A BOUNDARY SURVEY, AND NO FIELD WORK WAS PERFORMED TO VERIFY EXISTING BOUNDARY OR RIGHT-OF-WAY INFORMATION.

NOT VALID WITHOUT AN AUTHENTICATED ELECTRONIC SIGNATURE AND ELECTRONIC SEAL, OR THE SIGNATURE AND THE ORIGINAL RAISED SEAL OF A FLORIDA LICENSED SURVEYOR AND MAPPER.

THIS WHOLE PROPERTY LIES IN TWO FEMA FLOOD ZONES; THE CURRENT SURVEY LIES IN FEMA FLOOD ZONE X.

FEMA FIRM DATA:
FLOOD ZONE: X - ABOVE THE 500 YEAR FLOOD PLAIN
FLOOD PANEL: 1201CO357H
FLOOD DESIGNATIONS EFFECTIVE: 8/05/2014
AND
FLOOD ZONE: AH (EL 12)
FLOOD PANEL: 1201CO357H
FLOOD DESIGNATIONS EFFECTIVE: 8/05/2014

